

Rostfreie Kolbenventile - Wppv Serie / Stainless Piston Valves Wppv Series



Bestellnummer/Ordering Code

WPPV	PS	15
Model Model	Material Material	Anschlussgröße Port Size
WPPV : Stainless Piston Valve	Blank : Aluminium	10 : 3/8"
	PS :Stainless	15 : 1/2"
		20 : 3/4"
		25 : 1"
		32 : 1 - 1/4"
		40 : 1 - 1/2"
		50 : 2"

Spezifikation/ Specification

Model/Model	WPPV
Fluid/Fluid	Gases and Liquid
Arbeitstyp/Acting Type	Normally Closed
Steuerdruck/Control Pressure	4.0~8.0bar / 0.4~0.8MPa / 72~114 Psi
Flüssigkeitstemperatur/Fluid Temperature	-10 ~ + 200 °C
Temperatur/Temperature	-10 ~ + 60 °C

Technische Zeichnung/Technical Drawing

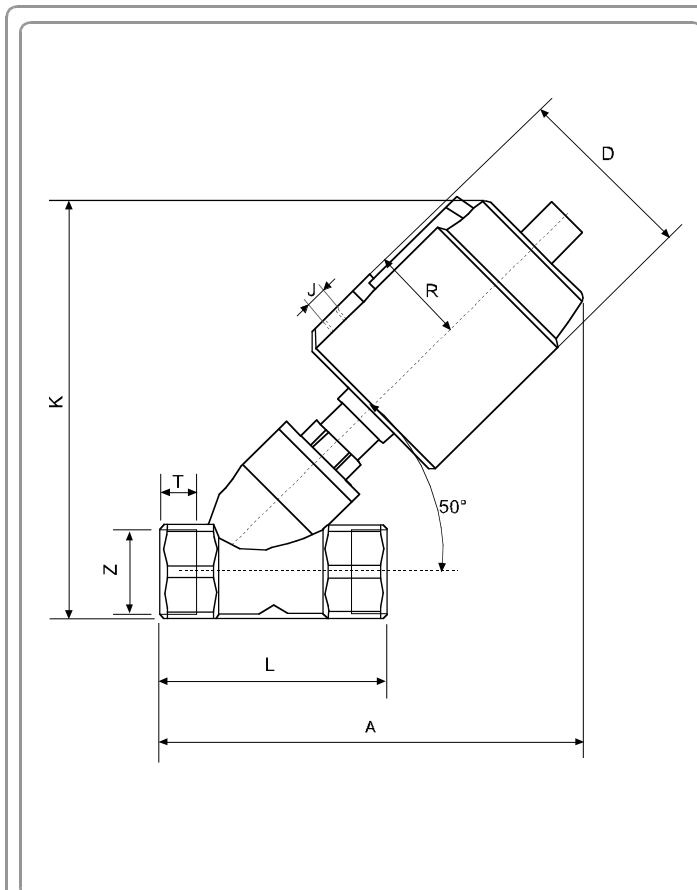

Item	A	D	G	K
WPPV - 10	110	47	3/8"	120
WPPV - 15	130	84	1/2"	140
WPPV - 20	140	84	3/4"	145
WPPV - 25	150	84	1"	160
WPPV - 32	200	96	1-1/4"	215
WPPV - 40	200	96	1-1/2"	215
WPPV - 50	215	96	2"	233
Item	L	R	T	J
WPPV - 10	60	27	13	1/8"
WPPV - 15	70	35	15	1/8"
WPPV - 20	80	35	17	1/8"
WPPV - 25	90	35	17	1/8"
WPPV - 32	115	50	20	1/8"
WPPV - 40	115	50	16	1/8"
WPPV - 50	138	50	20	1/8"